

RLM - Emblem Angle



24VDC Power System Compatibility:



Project:

Location:

Catalog #:

Quantity:

Features

Teslyte RLM Series are a traditional reflector lighting luminaires that features a highly efficient LED light engine that is compatible with 24V DC NEXTEK Power Systems. Constructed from heavy gage aluminum spun housing that is resistance to corrosion and weathering. The RLM Series has a contemporary and low profile look that will accent and enhance any outdoor or indoor space while providing maximum photometric and electrical performance.

- Housing:
 - Constructed out of heavy gage aluminum spun
- LEDs:
 - High quality LED for color consistency
- Finish:
 - Powder coat finish that provides superior resistance to corrosion and weathering
- Application:
 - Outdoor and Indoor for Commercial or Residential
- Mounting:
 - A variety of mounting options available
- Warranty:
 - 5 years warranty.

Ordering Information

Product code	Size Code	Voltage	Wattage	CCT (K)	Finish	Optional
RLM-EA	<input type="text"/>	24	<input type="text"/>	<input type="text"/>	<input type="text"/>	<input type="text"/>
	XXXX (1) Use Size Code table below for size of the fixture i.e. 0809 (8" Dia, 9" H.)	24 - 24V	115lm/watt 10W - 10W 15W - 15W	27 - 2700K 30 - 3000K 35 - 3500K 40 - 4000K	W -White B - Black S - Silver BR - Bronze C - Custom	M : Mounting Options*

Note: Fixtures must be grounded in accordance with national, state, and/or local electrical codes. Failure to do so may result in serious personal injury

* Mounting options: A – Arm, C – Cord, S – Stem, G – Gooseneck, F – Flush Mounting.

Mechanical Dimensions

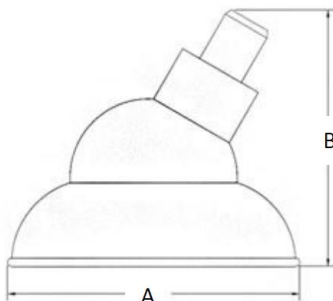

(1)Size Code	A - Diameter	B - Height
0706	7"	6"
0807	8"	7"
1009	10"	9"
1210	12"	10"

*Larger Sizes Available, Consult Factory.