

## Wall Recessed Step Light



### Features

Teslyte WR-ET Series is a compact and inconspicuous recessed step light that comes with two types of faceplates. The WR-ET recessed step light is ideal for illuminating pathways, and indoor or outdoor steps.

- Housing:
  - Die-casting aluminum housing
  - Silicone rubber gasket
- LEDs
  - Integral highly efficient SMD LED module and driver
- Optical Lens:
  - Polycarbonate diffuse lens
  - Two types of faceplates: Diffuse and Louver
- Finish:
  - Powder coat finish that provides superior resistance to corrosion and weathering.
- Application:
  - Pathways, indoor and outdoor stairs
- Warranty:
  - IP65
  - 3 years warranty

### Ordering Information

#### Product Code & Wattage

**WR-ET2301-S10-**  
S10- 10W (480 lms)<sup>(1)</sup>  
**WR-ET2301-S20-**  
S20- 20W

#### CCT

**3-** 3000K  
**4-** 4000K  
**5-** 5000K  
**R-** Red  
**G-** Green  
**B-** Blue

#### Ra

**80-** Ra80  
**90-** Ra90

#### Faceplate

**D-** Diffuse  
**L-** Louver

#### Faceplate color

**B -** Black  
**W -** White  
**G -** Gray  
**Z -** Mineral  
bronze  
**S -** Silver

#### Accessories

**M-** Marine  
ambient  
corrosion  
resistance  
**DMG-** 0 - 10V  
dimming

Volt: 100-277Vac

Note: (1) source lumen

### Options and Accessories

Diffuse

Louver

Faceplate Options



## Mechanical Dimensions

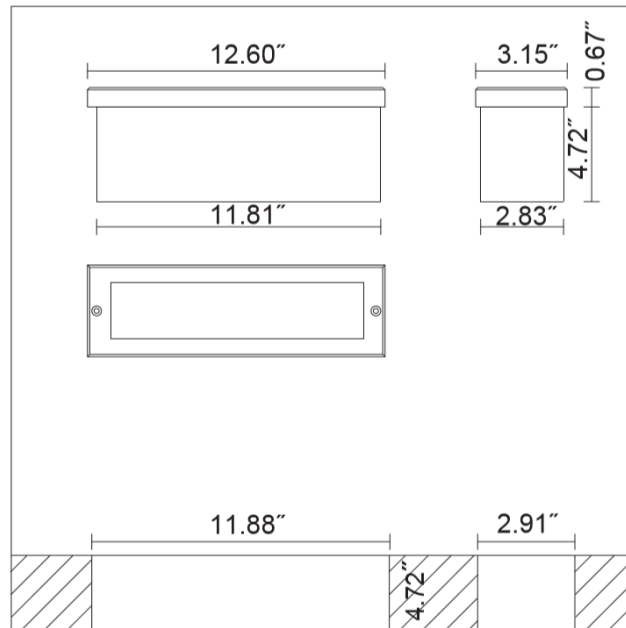

## Photometric Data

### LUMINOUS INTENSITY DISTRIBUTION DIAGRAM

